

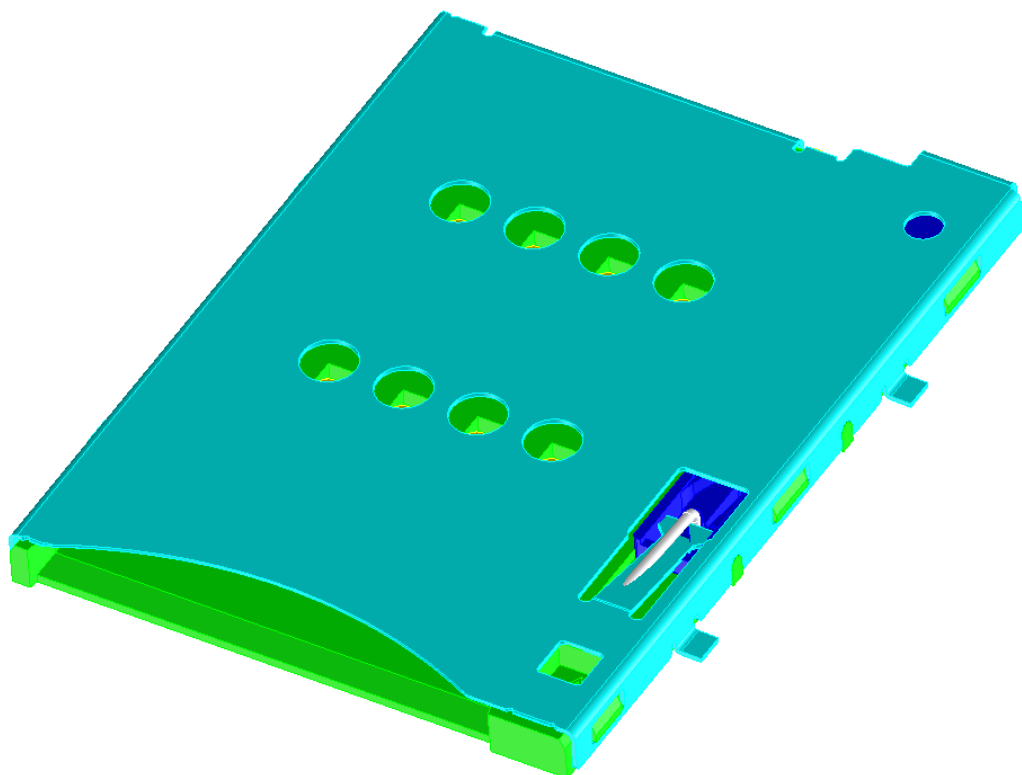

PRODUCT SPECIFICATION



育鼎精密工業股份有限公司
ACRON PRECISION INDUSTRIAL CO., LTD

桃園縣八德市廣德里新興路 55 號

No.55, SinSing Road., Bade City, Taoyuan County 334, Taiwan(R.O.C)

TEL : 886-3-3629889 FAX : 886-3-3664917

☐ 東莞睦永電子五金廠
(AMMI)

☐ 東莞育鼎電子五金廠
(ACRON)

☒ 東莞愷興電子科技電子有限公司
(NUCONN)

REVISION:	ECR/ECN INFORMATION:		PRODUCT NO	SCM16 Series	SHEET No
C	EC No:	RD-T170068	PRODUCT NAME	10Pin 1.27mm Pitch Sim CARD PUSH PUSH CONNECTOR	1 of 5
	DATE:	2017/12/20			
DOCUMENT NUMBER:		CREATED / REVISED BY:		CHECKED BY:	APPROVED BY:
PS-SCM-0011		ANDELEE.YANG		JERRY.TUNG	KIMI.HSU



PRODUCT SPECIFICATION

1.0 SCOPE

This Product Specification covers the performance requirements for 10 Pin 1.27mm sim card connector Push-Push series. .

2.0 PRODUCT DESCRIPTION

2.1 PRODUCT NAME AND SERIES NUMBER(S)

10Pin 1.27mm pitch sim card Push-Push connector **SCM16 series**

2.2 DIMENSIONS, MATERIALS, PLATINGS AND MARKINGS

See appropriate sales drawings for details on dimensions ,materials , plating and markings.

2.3 SAFETY AGENCY APPROVALS

See appropriate sales drawings

3.0 APPLICABLE DOCUMENTS AND SPECIFICATIONS

Please refer to the Sales Drawings , and other sections of this Specification for specific references to applicable documents and specifications. In cases where the Product Specification differs from the Sales Drawings, the Sales Drawing will take precedence

EIA-364 TEST METHODS FOR ELECTRICAL CONNECTORS

4.0 RATINGS

4.1 VOLTAGE

50 Volts DC

4.2 CURRENT

0.2 A Max.

4.3 TEMPERATURE

Operating Temperature Range: - 40°C to + 85°C

Storage Temperature Range: - 40°C to + 85°C

REVISION:	ECR/ECN INFORMATION:		PRODUCT NO	SCM16 Series	SHEET No
C	EC No:	RD-T170068	PRODUCT NAME	10Pin 1.27mm Pitch Sim CARD PUSH PUSH CONNECTOR	2 of 5
	DATE:	2017/12/20			
DOCUMENT NUMBER:		CREATED / REVISED BY:		CHECKED BY:	APPROVED BY:
PS-SCM-0011		ANDELEE.YANG		JERRY.TUNG	KIMI.HSU



PRODUCT SPECIFICATION

5.0 PERFORMANCE

Item	Test Items	Requirement	Procedures
1	Examination of Product	Meets requirements of product drawing. No physical damage.	Specimens shall be investigated by 10x (or higher) microscope.

Electrical Requirements

2	Contact Resistance (LLCR)	60 milliohms Max(Initial)	Subject mated contacts assembled in housing to 20mV maximum open circuit at 100mA maximum. EIA 364-23;
3	Insulation Resistance	1000 Mega Ohm Min.	After 500 VDC for 1 minute, measure the insulation resistance between the adjacent contacts of mated and unmated connector assemblies. EIA 364-21
4	Dielectric Withstanding Voltage	No breakdown; current leakage < 5mA	Apply a voltage 500 V DC for 1 minute between adjacent terminals and between terminals to ground. EIA 364-20

Mechanical Requirements

5	Durability	ΔR : 20 milliohms Max (change from initial)	Operation Speed: 500 cycles/hr. Durability Cycles: 5000 Cycles EIA 364-09.
6	Vibration	ΔR : 20 milliohms Max (change from initial) & No electrical discontinuity greater than 1 μ sec.	Subject mated connectors to 10-200-500 Hz traversed in 1minutes at 1.52mm amplitude for 0.5 Hour each of 3 mutually perpendicular planes.1.67Grms EIA 364-28; Test condition I
7	Mechanical Shock	ΔR : 20 milliohms Max (change from initial) & No electrical discontinuity greater than 1 μ sec.	Accelerate Velocity: 490m/ s ² (50G) Waveform: 11ms Half-sine shock Velocity Change: 3.4m/s No. of Drops: 3 drops each to normal and reversed directions of X,Y and Z axes, totally 18 drops, passing 1mA current during the test. EIA 364-27;Test Condition C

Environment Requirements

REVISION:	ECR/ECN INFORMATION:		PRODUCT NO	SCM16 Series	SHEET No
C	EC No:	RD-T170068	PRODUCT NAME	10Pin 1.27mm Pitch Sim CARD PUSH PUSH CONNECTOR	3 of 5
	DATE:	2017/12/20			
DOCUMENT NUMBER:		CREATED / REVISED BY:		CHECKED BY:	APPROVED BY:
PS-SCM-0011		ANDELEE.YANG		JERRY.TUNG	KIMI.HSU



PRODUCT SPECIFICATION

8	Insertion/Extraction force	Insertion Force : Initial : 30N Max. After Test : 30N Max. Extraction Force : Initial : 0.5N~3.0N After Test : 0.5N ~3.0N	Insertion and Extraction at speed of 25 mm/minute. Except influence of the force for eject and module lock mechanism.
9	Thermal Shock	ΔR : 20 milliohms Max. (change from initial) & Appearance: no damage	Place free situation samples in chamber with 10 cycles, and one duration is -40°C/(1.5h)~ 85°C/(1.5h). EIA-364-32
10	Static Humidity	ΔR : 20 milliohms Max. (change from initial) & Appearance: no damage	Test mated connector in chamber and expose to a temperature of 60 ± 2°C with a relative humidity of 95%RH for 240 hours. Note: Remove surface moisture and air dry for 1 hour prior to measurements. EIA 364-31
11	Solder ability	Solder coverage: 95% MINIMUM	Dip solder tails into the molten solder(held at 245±5°C for 3 ±0.5 sec. EIA 364-52
12	Solder Heat Resistance	Visual: No Damage to insulator material	Place connector on applicable P.C.B footprint and float on solder bath at 260±5 °C for 10±2 seconds. EIA 364-56 ; Refer to Fig.1
13	Salt Spray	ΔR : 20 milliohms Max. (change from initial) & Appearance: no damage	Duration: 48 hours exposure; Atmosphere:salt spray from a 5% solution. Temperature: 35 +1/-2°C EIA 364-26
14	Heat Temperature Life	ΔR : 20 milliohms Max. (change from initial) & Appearance: no damage	Simulate mated situation samples at 70°C for 240 hours. EIA 364-17
15	Cold Temperature Life	ΔR : 20 milliohms Max. (change from initial) & Appearance: no damage	Simulate mated situation samples at -20°C for 240 hours EIA 364-17

6.0 PACKAGING

Parts shall be packaged to protect against damage during handling, transit and storage. See packaging appropriate drawings

REVISION:	ECR/ECN INFORMATION:		PRODUCT NO	SCM16 Series	SHEET No
C	EC No:	RD-T170068	PRODUCT NAME	10Pin 1.27mm Pitch Sim CARD PUSH PUSH CONNECTOR	4 of 5
	DATE:	2017/12/20			
DOCUMENT NUMBER:		CREATED / REVISED BY:		CHECKED BY:	APPROVED BY:
PS-SCM-0011		ANDELEE.YANG		JERRY.TUNG	KIMI.HSU

7.0 RECOMMENDED REFLOW PROFILE

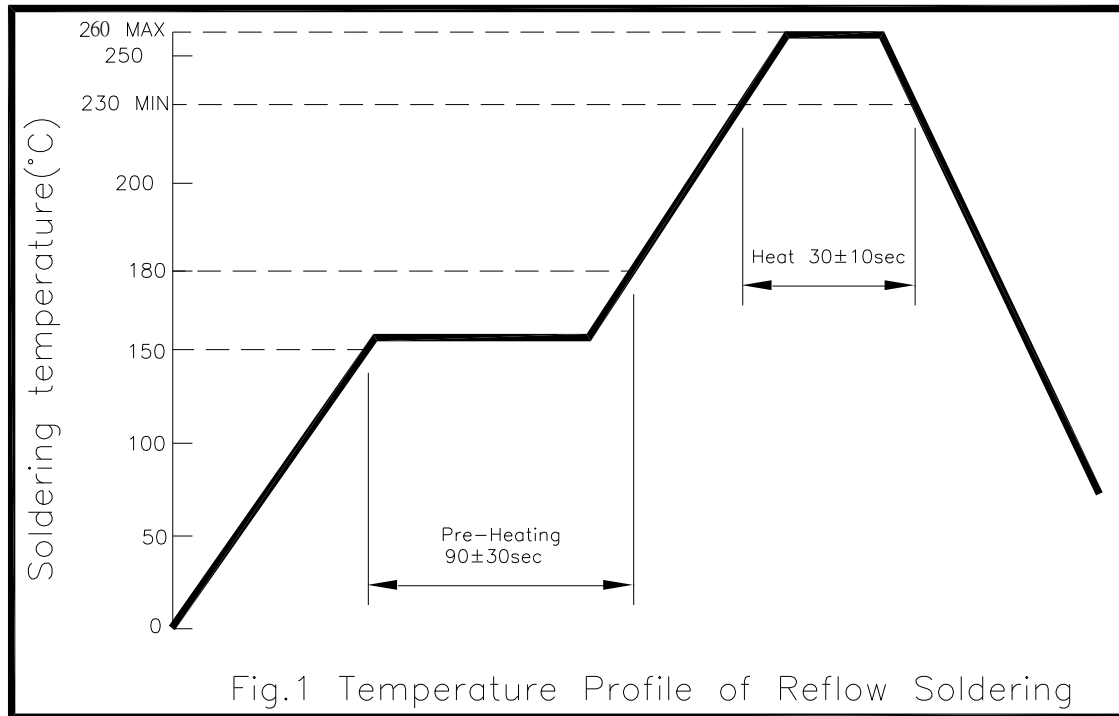

8.0 TEST GROUP

Test Items	Test Sequence											
	A	B	C	D	E	F	G	H	I	J	K	L
Examination of Product	1,6	1,8	1,6	1,6	1,6	1,6	1,6	1,6	1,5	1,3	1,3	
Contact Resistance(LLCR)	3	3,6	3,5	3,5	3,5	3,5	3,5	3,5	2,4			
Insulation Resistance	4											
Dielectric Withstanding Voltage	5											
Durability		5										
Mate and Um-mate Forces		4,7										
Vibration			4									
Mechanical Shock				4								
Humidity					4							
Heat Temperature Life						4						
Cold Temperature Life							4					
Thermal Shock								4				
Salt Spray Test									3			
Solder-ability Test										2		
Resistance to reflow soldering heat	2	2	2	2	2	2	2	2			2	
Sample(Pcs)	3	3	3	3	3	3	3	3	3	3	3	

REVISION:	ECR/ECN INFORMATION:		PRODUCT NO	SCM16 Series	SHEET No
C	EC No:	RD-T170068	PRODUCT NAME	10Pin 1.27mm Pitch Sim CARD PUSH PUSH CONNECTOR	5 of 5
	DATE:	2017/12/20			
DOCUMENT NUMBER:		CREATED / REVISED BY:		CHECKED BY:	APPROVED BY:
PS-SCM-0011		ANDELEE.YANG		JERRY.TUNG	KIMI.HSU

AdRON 文件制訂、修訂、廢止申請單

文件編號	PS-SCM-0011	文件名稱	SCM16 Series		
申請部門	工程部	申請人	楊嘉娟	日期	12/20'17
制訂單位	工程部	制訂人	莊玫瑰	日期	12.20'17
<input type="checkbox"/> 制訂 <input checked="" type="checkbox"/> 修訂 <input type="checkbox"/> 廢止原因說明	<p>(ECR) No. RC-T170068 (Rev.C)</p> <p>刪除：5.Current Rating & 9.Normal Force Test Items。 增加：Test Group</p>				
相關單位審查	<p>Amber 12/20/17</p> <p>M 12/21</p> <p>ly 12/20</p>				
核准	<p>Sam 12/20/17</p>				